



brands you trust.



Cast Steel Gate, Globe, Check Valves
CL150/CL300

CRANE®-C



www.upcc.com.ph

CRANE

Energy Process Solutions

47XU-F

Cast Steel Gate Valve

Class 150

Features & Benefits

- Efficient stop valves with flow in either direction
- Commonly used where a minimum pressure drop is important
- Flexible wedge disc compensates for deformation of body due to pipe stress
- Outside screw and yoke
- Flanged
- Seat ring is seal welded to eliminate leak paths

Materials

PART	MATERIAL
Body	A216 WCB
Bonnet	A216 WCB
Seat Rings	Hardfaced
Disc	CA-15 or 13% CR Overlay
Stem	410 SS
Packing	Graphite
Bonnet Gasket	Soft Iron
Back Seat	410 SS
Yoke Sleeve	D2 Ni-Resist
Retaining Nut	Malleable or Steel
Gland	Steel
Gland Flange	Steel
Eye Bolt	Steel
Eye Bolt Nuts	Steel
Pins	Steel
Bonnet Studs	A193 Gr. B7
Bonnet Nuts	A194 Gr. 2H
Handwheel	Malleable, Ductile or Steel
Handwheel Nut	Ductile or Steel
ID Tags	SS
ID Pins	Steel
Spacer	Steel
Grease Fittings	Steel



Dimensional Drawing

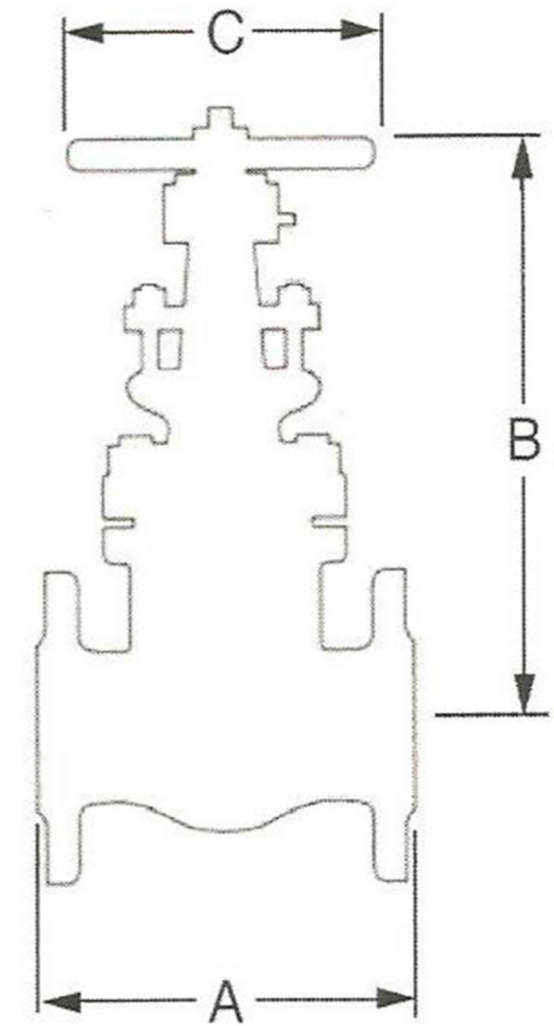

Dimensions & Weights

SIZE (inch)	WEIGHT (lbs)	A (inch)	B VALVE OPEN (inch)	C (inch)
2	46	7.00	16.50	8.00
2 1/2	70	7.50	18.00	8.00
3	76	8.00	21.00	9.00
4	110	9.00	23.00	10.00
6	175	10.50	31.00	12.00
8	310	11.50	39.00	14.00
10	455	13.00	46.75	16.00
12	650	14.00	55.00	18.00
14	860	15.00	60.50	20.00
16	1120	16.00	68.50	20.00
18	1400	17.00	77.50	23.62
20	2125	18.00	84.00	23.62
24	3120	20.00	99.00	28.35

Industry Standards

STEEL VALVES	ANSI B16.34
FACE-TO-FACE/END-TO-END	ANSI B16.10
FLANGE DIMENSIONS	ANSI B16.5
BASIC DESIGN	API 600
TESTING	API 598
ACCEPTANCE	API RP591

Intermediate pressure ratings shall be determined by interpolation.

SIZE RANGE: 2 - 24 inches **PRESSURE TEMPERATURE RATING:** Class 150

Carbon Steel
ASTM A216 Grade WCB
285 psi @ -20°F to 100°F

Every effort has been made to ensure that the information contained in this publication is accurate at the time of publishing. Crane Ltd assumes no responsibility or liability for typographical errors or omissions or for any misinterpretation of the information within the publication and reserves the right to change without notice.

33XU-F

Cast Steel Gate Valve

Class 300

Features & Benefits

- Efficient stop valves with flow in either direction
- Commonly used where a minimum pressure drop is important
- Flexible wedge disc compensates for deformation of body due to pipe stress
- Outside screw & yoke
- Flanged
- Seat ring is seal welded to eliminate leak paths

Materials

PART	MATERIAL
Body	A216 WCB
Bonnet	A216 WCB
Seat Rings	Hardfaced
Disc	CA-15 or 13% CR Overlay
Stem	410 SS
Packing	Graphite
Bonnet Gasket	Spiral Wound
Back Seat	410 SS
Yoke Sleeve	D2 Ni-Resist
Retaining Nut	Malleable or Steel
Disc Washer	Carbon Steel
Gland	Steel
Gland Flange	Steel
Eye Bolt	Steel
Eye Bolt Nuts	Steel
Pins	Steel
Bonnet Studs	A193 Gr. B7
Bonnet Nuts	A194 Gr. 2H
Handwheel	Malleable, Ductile or Steel
Handwheel Nut	Ductile or Steel
ID Tags	SS
ID Pins	Steel
Spacer	Steel
Grease Fittings	Steel



Dimensional Drawing

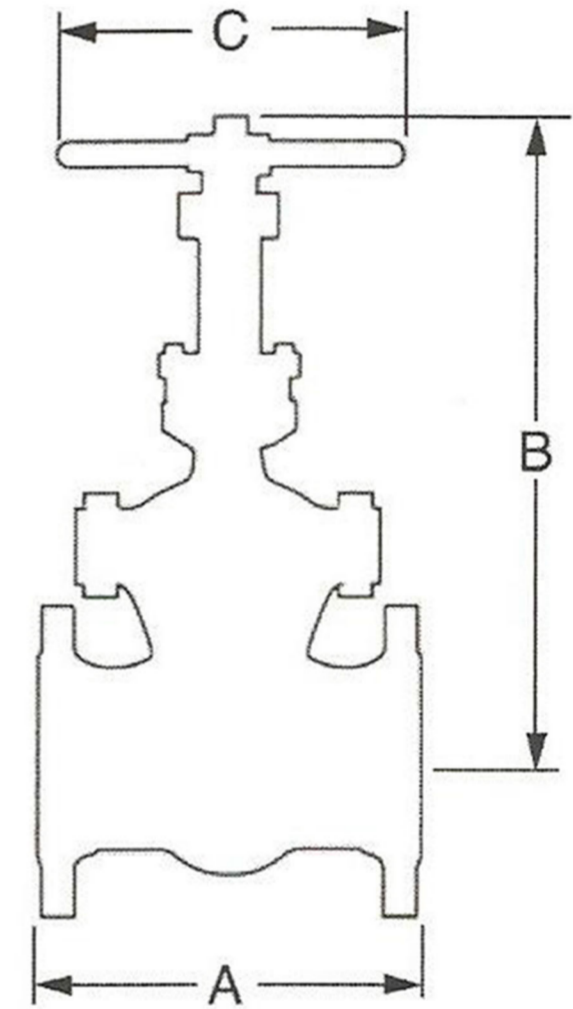

Dimensions & Weights

SIZE (inch)	WEIGHT (lbs)	A (inch)	B VALVE OPEN (inch)	C (inch)
2	74	8.50	16.00	8.00
2 1/2	80	9.50	19.00	8.00
3	108	11.12	22.00	9.00
4	165	12.00	25.00	10.00
6	320	15.88	32.75	14.00
8	500	16.50	40.00	16.00
10	760	18.00	49.50	18.00
12	1020	19.75	57.50	20.00
14	1380	30.00	64.50	20.00
16	1960	33.00	71.50	24.00
18	2450	36.00	78.50	23.62
20	3890	39.00	86.50	28.35
24	6292	45.00	104.00	35.43

Industry Standards

STEEL VALVES	ANSI B16.34
FACE-TO-FACE/END-TO-END	ANSI B16.10
FLANGE DIMENSIONS	ANSI B16.5
BASIC DESIGN	API 600
TESTING	API 598
ACCEPTANCE	API RP591

Intermediate pressure ratings shall be determined by interpolation.

SIZE RANGE: 2 - 24 inches **PRESSURE TEMPERATURE RATING:** Class 300

Carbon Steel
ASTM A216 Grade WCB
285 psi @ -20°F to 100°F

Every effort has been made to ensure that the information contained in this publication is accurate at the time of publishing. Crane Ltd assumes no responsibility or liability for typographical errors or omissions or for any misinterpretation of the information within the publication and reserves the right to change without notice.

143XU

Cast Steel Globe Valve

Class 150

Features & Benefits

- Ideal for throttling service
- Flow characteristics permit accurate and repeatable flow control
- Seat ring is seal welded to eliminate leak paths
- Outside screw & yoke
- Bolted bonnet

Materials

PART	MATERIAL
Body	A216 WCB
Bonnet	A216 WCB
Seat Rings	Hardfaced
Disc	13% CR Overlay
Stem	410 SS
Packing	Graphite
Bonnet Gasket	Soft Iron
Back Seat	410 SS
Disc Stem Nut	410 SS
Disc Washer	Carbon Steel
Gland	410 SS
Gland Flange	WCB
Eye Bolt	Steel
Eye Bolt Nuts	A563 Gr. A or O
Pins	-
Bonnet Studs	A193 Gr. B7
Bonnet Nuts	A194 Gr. 2H
Handwheel	WCB
Handwheel Nut	A194 Gr. 2H
ID Tags	SS
ID Pins	Steel

Dimensions & Weights

SIZE (inch)	WEIGHT (lbs)	A (inch)	B VALVE OPEN (inch)	C (inch)
2	53	8.00	14.00	8.00
2 1/2	70	8.50	15.00	8.00
3	90	9.50	17.00	10.00
4	143	11.50	20.00	12.00
6	246	16.50	24.00	16.00
8	392	19.50	25.00	16.00
10	605	24.50	29.00	20.00
12	900	27.50	38.00	20.00

SIZE RANGE: 2 - 12 inches **PRESSURE TEMPERATURE RATING:** Class 150
 Carbon Steel
 ASTM A216 Grade WCB
 285 psi @ -20°F to 100°F



Dimensional Drawing

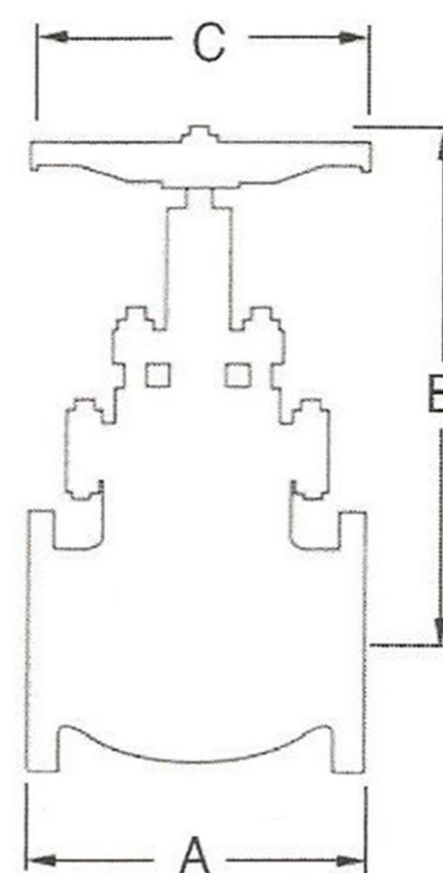

Industry Standards

STEEL VALVES	ANSI B16.34
FACE-TO-FACE/END-TO-END	ANSI B16.10
FLANGE DIMENSIONS	ANSI B16.5
TESTING	API 598
ACCEPTANCE	API RP591

Intermediate pressure ratings shall be determined by interpolation.

Every effort has been made to ensure that the information contained in this publication is accurate at the time of publishing. Crane Ltd assumes no responsibility or liability for typographical errors or omissions or for any misinterpretation of the information within the publication and reserves the right to change without notice.

151XU

Cast Steel Globe Valve

Class 300

Features & Benefits

- Ideal for throttling service
- Flow characteristics permit accurate and repeatable flow control
- Seat ring is seal welded to eliminate leak paths
- Outside screw & yoke
- Bolted Bonnet

Materials

PART	MATERIAL
Body	A216 WCB
Bonnet	A216 WCB
Seat Rings	Hardfaced
Disc	13% CR Overlay
Stem	410 SS
Packing	Graphite
Bonnet Gasket	Spiral Wound
Back Seat	410 SS
Disc Stem Nut	410 SS
Disc Washer	Carbon Steel
Gland	410 SS
Gland Flange	WCB
Eye Bolt	Steel
Eye Bolt Nuts	A563 Gr. A or O
Pins	-
Bonnet Studs	A193 Gr. B7
Bonnet Nuts	A194 Gr. 2H
Handwheel	WCB
Handwheel Nut	A194 Gr. 2H
ID Tags	SS
ID Pins	Steel



Dimensional Drawing

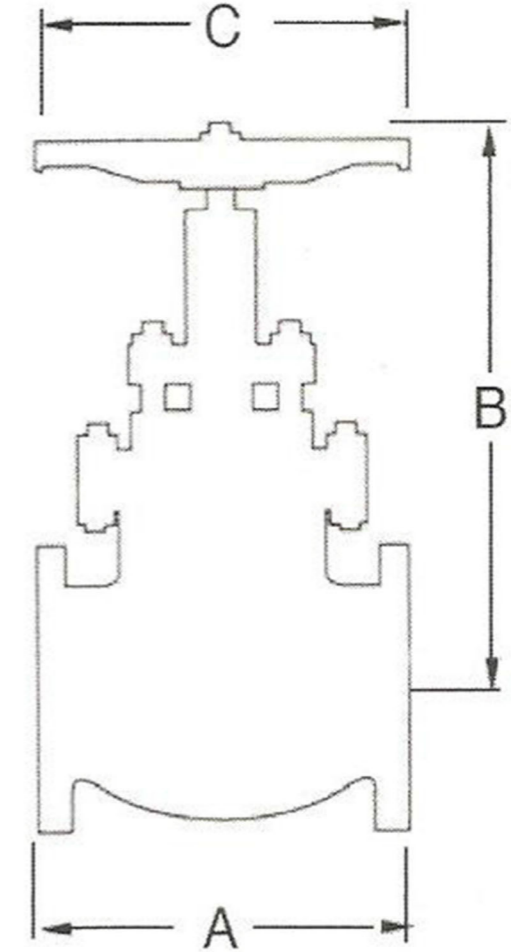

Dimensions & Weights

SIZE (inch)	WEIGHT (lbs)	A (inch)	B VALVE OPEN (inch)	C (inch)
2	75	10.50	16.75	8.00
2 1/2	99	11.50	18.00	10.00
3	132	12.50	21.00	10.00
4	209	14.00	23.00	14.00
6	440	17.50	36.00	18.00
8	693	22.00	39.00	24.00
10	1008	24.50	41.00	24.00
12	1100	28.00	48.00	24.00

Industry Standards

STEEL VALVES	ANSI B16.34
FACE-TO-FACE/END-TO-END	ANSI B16.10
FLANGE DIMENSIONS	ANSI B16.5
TESTING	API 598
ACCEPTANCE	API RP591

Intermediate pressure ratings shall be determined by interpolation.

SIZE RANGE: 2 - 12 inches **PRESSURE TEMPERATURE RATING:** Class 150

Carbon Steel
ASTM A216 Grade WCB
285 psi @ -20°F to 100°F

Every effort has been made to ensure that the information contained in this publication is accurate at the time of publishing. Crane Ltd assumes no responsibility or liability for typographical errors or omissions or for any misinterpretation of the information within the publication and reserves the right to change without notice.

147XU

Swing Check Valve

Class 150

Features & Benefits

- Cast Steel, bolted cap and flanged
- Swing check valves prevent reversal of flow through the pipeline
- Can be installed in horizontal or vertical, upward flow piping
- Offer low resistance to flow and are particularly suited to low velocity service
- Seat ring is seal welded to eliminate leak paths

Materials

PART	MATERIAL
Body	A216 WCB
Cap	A216 WCB
Seat Ring	Hardfaced
Disc	13% CR Overlay
Hinge	WCB
Pins, Hinge	410 SS
Disc Washer	Steel
Cap Screw	A307 Gr. B
Cap Gasket	Soft Iron
Cap Studs	A193 Gr. B7
Cap Nuts	A194 Gr. 2H
ID Tags	SS
ID Pins	Steel

Dimensions & Weights

SIZE (inch)	WEIGHT (lbs)	A (inch)	B VALVE OPEN (inch)
2	33	8.00	6.75
2½	57	8.50	7.12
3	59	9.50	7.38
4	93	11.50	8.50
6	165	14.00	10.25
8	275	19.50	11.88
10	440	24.50	13.88
12	680	27.50	15.75
14	950	31.00	17.75
16	1225	34.00	19.00
18	1700	38.50	21.25
20	1850	38.50	23.58
24	2900	51.00	26.75

SIZE RANGE: 2 - 24 inches
PRESSURE RATING: Class 150
 Carbon Steel
 ASTM A216 Grade WCB
 285 psi @ -20°F to 100°F

SPECIFICATION: Swing check valves prevent reversal of flow through pipelines. Most Crane FS swing check valves can be installed in horizontal or vertical upward flow piping. They offer low resistance to flow and are particularly suited to low velocity service.



Dimensional Drawing

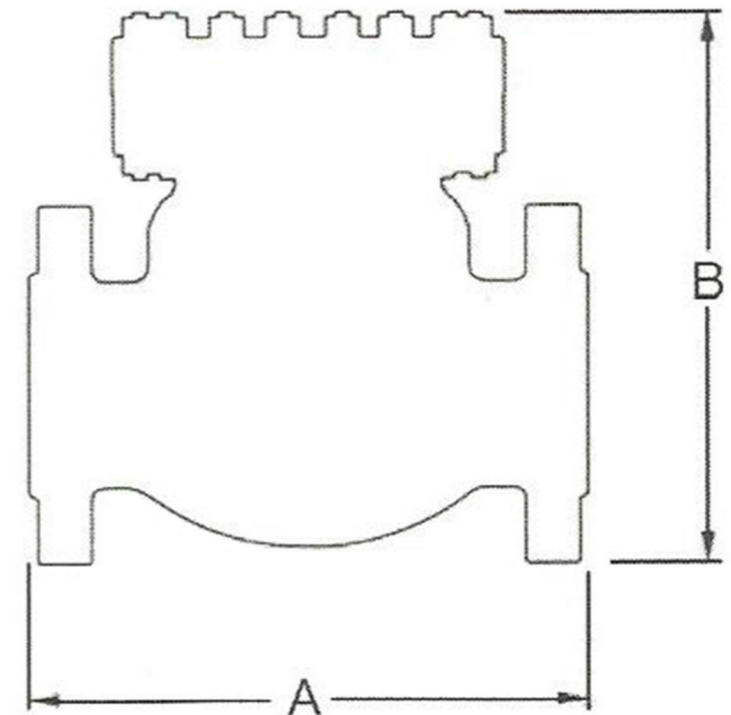

Industry Standards

STEEL VALVES	ANSI B16.34
FACE-TO-FACE/END-TO-END	ANSI B16.10
FLANGE DIMENSIONS	ANSI B16.5
TESTING	API 598
ACCEPTANCE	API RP591

Intermediate pressure ratings shall be determined by interpolation.

159XU

Swing Check Valve

Class 300

Features & Benefits

- Cast Steel, bolted cap and flanged
- Swing check valves prevent reversal of flow through the pipeline
- Can be installed in horizontal or vertical, upward flow piping
- Offer low resistance to flow and are particularly suited to low velocity service
- Seat ring is seal welded to eliminate leak paths

Materials

PART	MATERIAL
Body	A216 WCB
Bonnet	A216 WCB
Seat Ring	Hardfaced
Disc	13% CR Overlay
Hinge	WCB
Pins, Hinge	410 SS
Cap Screw	A307 Gr. B
Cap Gasket	Spiral Wound
Cap Studs	A193 Gr. B7
Cap Nuts	A194 Gr. 2H
ID Tags	SS
ID Pins	Steel

Dimensions & Weights

SIZE (inch)	WEIGHT (lbs)	A (inch)	B VALVE OPEN (inch)
2	46	10.50	6.75
2 1/2	66	11.50	7.38
3	86	12.50	8.50
4	154	14.00	9.25
6	276	17.50	11.88
8	420	21.00	13.38
10	640	24.50	13.88
12	1000	28.00	16.62
14	1550	33.00	18.88
16	1700	34.00	20.50
18	2200	38.50	23.62
20	2800	44.00	26.38
24	3650	53.00	29.62

SIZE RANGE: 2 - 24 inches

PRESSURE RATING: Class 300
Carbon Steel

ASTM A216 Grade WCB

285 psi @ -20°F to 100°F

SPECIFICATION: Swing check valves prevent reversal of flow through pipelines.

Most Crane FS swing check valves can be installed in horizontal or vertical upward flow piping. They offer low resistance to flow and are particularly suited to low velocity service.

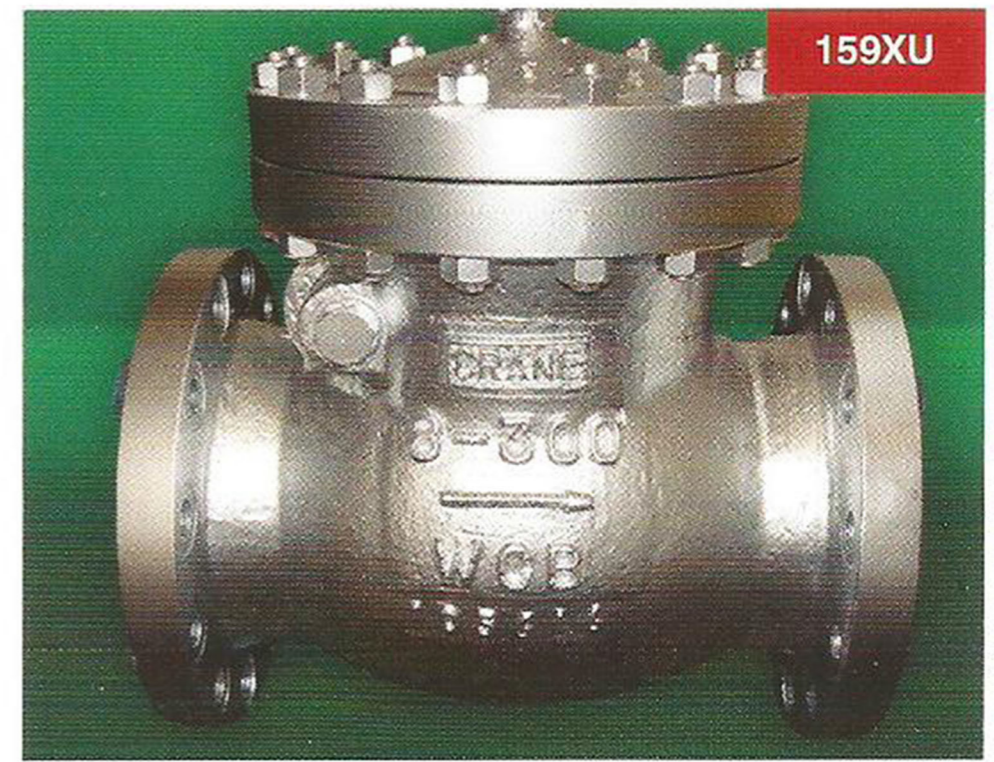

Dimensional Drawing

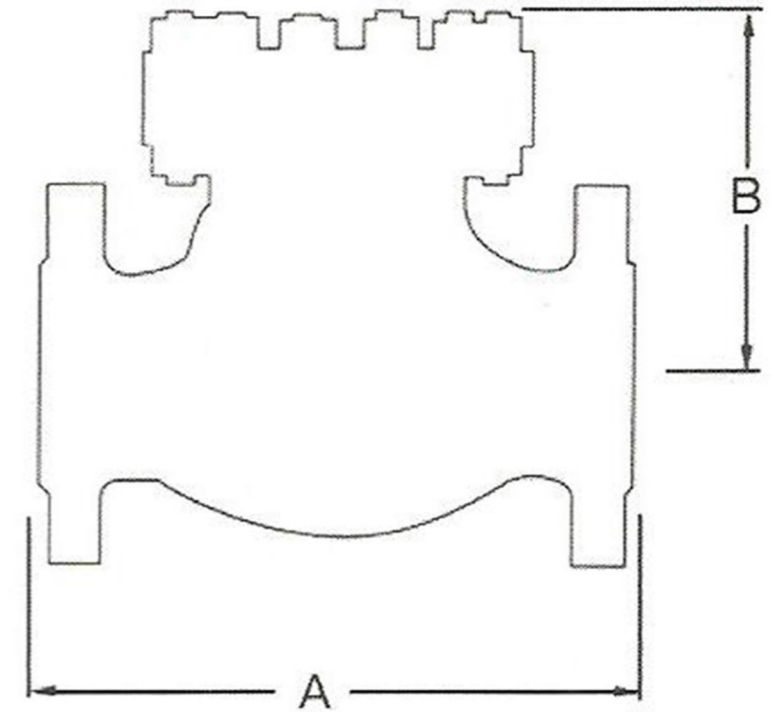

Industry Standards

STEEL VALVES	ANSI B16.34
FACE-TO-FACE/END-TO-END	ANSI B16.10
FLANGE DIMENSIONS	ANSI B16.5
TESTING	API 598
ACCEPTANCE	API RP591

Intermediate pressure ratings shall be determined by interpolation.